



Motor Flange ATMK 16

Order no. 1020533

Easy Mounting

We offer prefabricated motor flanges in suitable sizes for ATMK12 and ATMK16. They can easily be completed and mounted according to the motor dimensions.

Included in the delivery are the vacuum screws fitting for the mounting of the motor cone to the motor flange. Additional sizes can be delivered.

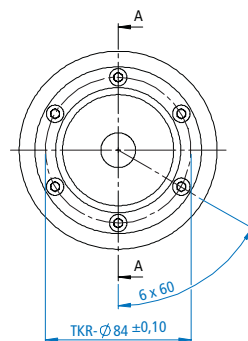
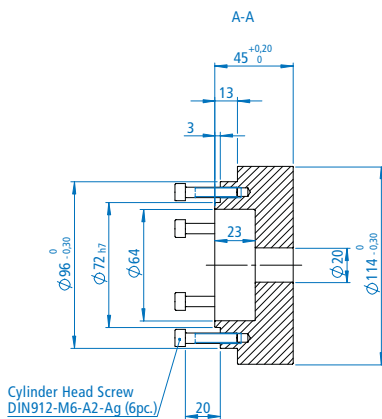

Motor Flange	ATMK16
Order no.	1020533
Material	Aluminium
Weight in kg	1,000
Delivery parts	
Cylinder head screw (6 pc.)	M6-A2-Ag

Motor Flanges, completed

Save time and money!

We can also produce the complete motor flange for you. Just tell us the dimensions of your motor and we set up construction and a quotation for you, for the requirements of your drive system.

This is what we need from you:

- Motor shaft diameter
- Motor shaft length
- Diameter centering device
- Position and number of mounting drills
- Would you like the matching screws ?

example of completed motor flange



ALMA driving elements GmbH
 Obere Heeg 5
 D-97852 Schollbrunn
 T+49 (0) 93 94 / 97 00 - 0
 F+49 (0) 93 94 / 97 00 - 50
 info@alma-driving.de
 www.alma-driving.de

Part.No. 1020533
 09/2002
 Subject to alterations
 © by ALMA driving elements